

1 2 3 4 5 6 7 8

A

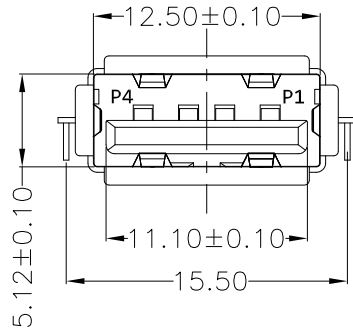

B

C

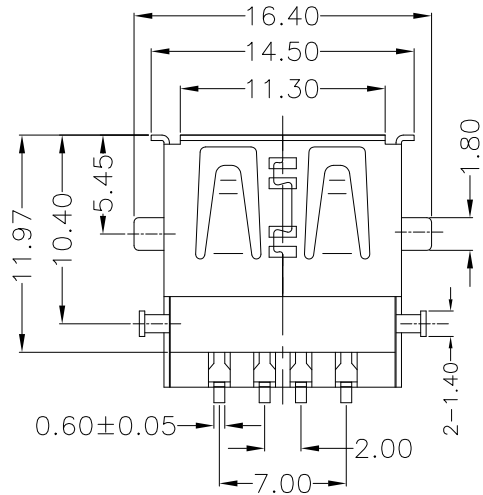

D

E

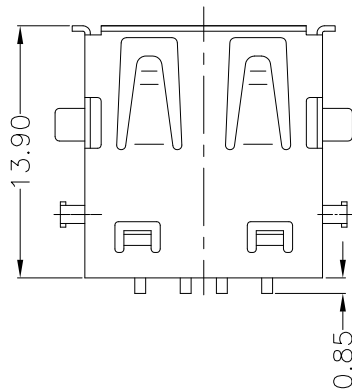

F

G

H

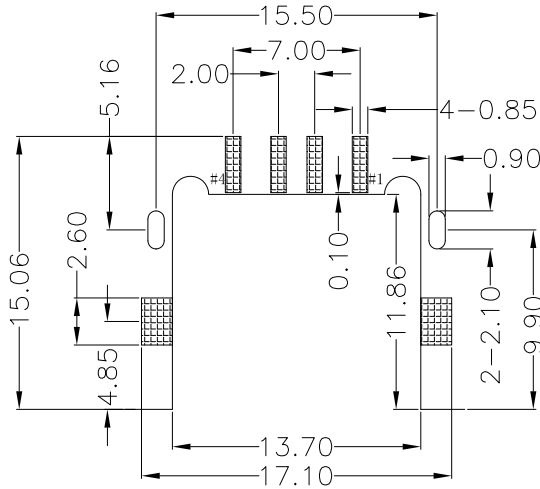
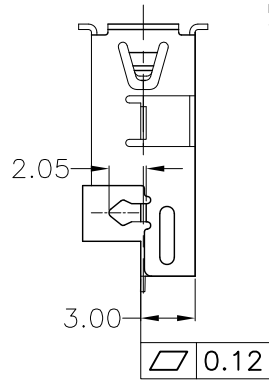

RECOMMENDED PCB LAYOUT
TOLERANCE ±0.05 PCB 1.6t

1.Material:

Contacts : C5191
Insulator: LCP+30% G.F. UL 94V-0
Shell : SUS301

2.Mechanical:

Mating: 35N max.
Withdrawal Force: 10~35N
Durability: 1500 cycles min.

3.Electrical:

Current-max[amps] 1.5A
Voltage-max[volts] 30V
Withstanding Voltage 500V AC
Contact Resistance [ohms] 30 milliohms max
Insulation Resistance [ohms] 1000 Megohms min

4.Plating:

Contacts: Gold Flash And Tin Plated Over All
Shell: Nickel over all plating

5.Environmental

Temperature Range -55°C~+85°C



ORDER INFORMATION

SERIES NO.	Contact Plated	Packaging	Shell Plated	Shell Leg	Shell Leg Width	Housing Color	Post	Back Cover	Edge Curl				
6RS	A	R	R	G1	X	D	3	S	B	0	1	1	67
USB 2.0 SMT Reverse Sunk	A Type	P: Plug R: Receptacle	R: Right Angle V: Vertical	G1: Gold Flash	2: T&R 3: Tray	Stainless D: Nickel	3: Front 2xSMT Rear 2xDIP	S: 15.5	B: Black LCP	0: w/o 1: with	0: w/o 1: with	0: w/o 1: with	

REV.	REVISION RECORD	DATE	General Tolerances			
A	Original	09/15/17	LINEAR 0.0 ±0.35 0.00±0.20	ANGLES ±3°		
				UNIT: mm	TITLE: USB A Female SMT Right Angle Sunk Reverse DWG.NO. 6RSARRG1XD3SB011-67 SCALE 1 : 1 SHEET 1 OF 1	
			A4	NAME		DATE
			APPROVED	WENDY		
			DESIGNER	WHITE		
			DRAWN	ANGEL		